



### APPLICATIONS

Usage monitoring, such as:

- Industrial wastewater discharge monitoring
- Cooling tower deduct metering
- Heap leach mining discharge monitoring
- Well monitoring
- Turf and landscape water monitoring

### FEATURES

- Simple as a mechanical meter
- No moving parts
- Minimal straight pipe required
- Battery powered
- Built-in rate & total indicator
- Corrosion resistant
- Pulse output (WMP101 only)

### GENERAL INFORMATION

The WMP-Series is a full-bore, plastic-bodied electromagnetic flow meter designed for flow and usage monitoring applications in 1 and 2 inch pipe. The polypropylene flow tube offers corrosion resistance to a wide range of chemicals. Its light weight and easy to install or remove from the pipe for inspection\*.

With no moving parts, the magmeter permits unobstructed flow, minimizing flow disturbances and hence, straight pipe requirements. The WMP-Series can be used in piping configurations where there is little space between the meter and an elbow or valve. The WMP-Series, like other magmeters, are resistant to wear from sand and debris found in ground or surface water. Since there are no bearings or propeller to wear out, downtime and maintenance and repair costs are kept to a minimum. Because there are no mechanical parts in the flow stream, the meter tolerates high flows without damage.

The hinged, opaque polyethylene cover protects from dust and UV rays, while permitting easy access to the LCD flow rate and total display. The electronics housing is made of rugged powder-coated die-cast aluminum. It can be fitted with cross-drilled screws and seal wire for tamper-evidence. Flow rate and total can be displayed in a variety of units, customer-selected and factory-set.

The WMP-Series is used for tracking flow rate and total flow in usage monitoring applications, for instance, in compliance with regulatory requirements. These would include wells, industrial wastewater, heap leach mining discharge, cooling tower deduct metering, turf and landscape applications, and other water reclamation operations. In the event of DC power loss, or when changing the battery, the WMP is designed to retain the internal settings and flow total.

The **WMP101** is externally powered via a 5-pin connector cable which also provides pulse output for use with a variety of Seametrics and other displays and controls for remote reading, data logging, pulse-to-analog conversion, and telemetry applications.

The **WMP104** is a battery-operated unit for use when pulse output is not required. The standard batteries are user replaceable with an approximate 1-2 year life depending on usage. An extended battery life option offers an estimated 2-4 year life depending on usage.

*\*Use Banjo® fittings or Seametrics NPT Fitting Kit, if required (2" model only).*

## FEATURES

Polyethylene protective cover

LCD rate and total indicator

Powder-coated diecast-aluminum electronics housing

Cross-drilled screws (2) for tamper-evidence

316SS electrodes

Corrosion-resistant glass-filled polypropylene body

Lightweight for easy handling



**Seametrics Fitting Kit  
for 2 inch model**

## SPECIFICATIONS\*

**2 inch**

<b>Pipe Size</b>		1 or 2 inch full port		
<b>Fittings</b>		1 inch NPTF, 2 inch flange clamps with optional 2 inch NPTF fitting kit		
<b>Pressure</b>		150 psi or 10.3 bar working pressure @ 70° F		
<b>Operating Temperature Range</b>		10° to 130° F (-12° to 54° C) operating, -40° to 176° F (-40° to 80° C) non-operating		
<b>Accuracy</b>		+/-1% of reading from 100% to 10% of full scale		
		+/-3% of reading from 10% of full scale to cut off		
<b>Flow Range</b>	<b>Minimum</b>	1 inch: 2.3 gallons per minute (.145 liters per second)		2 inch: 6 gallons per minute (.38 liters per second)
	<b>Maximum</b>	1 inch: 110 gallons per minute (6.94 liters per second)		2 inch: 300 gallons per minute (18.9 liters per second)
<b>Materials</b>	<b>Body</b>	Glass-filled polypropylene		
	<b>Electrodes</b>	316 stainless steel		
	<b>Electronics Housing</b>	Diecast aluminum, powder-coated		
	<b>Display Cover</b>	Polyethylene		
<b>Display</b>	<b>Rate</b>			<b>Total</b>
	<b>Digits</b>	6		8
	<b>Units</b>	Gallons/Minute, Cubic Feet/Second, Cubic Feet/Minute, Liters/Second Liters/Minute, Cubic Meters/Minute		Acre-Feet, Acre-Inch, Gallons, Gallons x 1000, Cubic Feet, Liters, Megaliters, Cubic Meters
<b>Security</b>		Cross-drilled screws and tamper-evident seal (optional)		
<b>Power</b>	<b>WMP101</b>	10-30 Vdc @ 60 mA max (15 mA average) NOTE: Using an unregulated power supply >18 Vdc may damage the meter due to AC line input voltage fluctuation		
	<b>WMP104</b>	6 each AA alkaline cells, replaceable. Estimated life is 1-2 years depending on usage (standard)		
		2 each C lithium batteries, replaceable. Estimated life is 2-4 years depending on usage (Extended battery life option)		
<b>Pulse Output (WMP101 Only)</b>				
	<b>Signal</b>	Current sinking pulse, opto isolated, 32 Vdc max at 10 mA max		
	<b>Standard Pulse Rate</b>	1 unit/pulse out, pulse width of 10ms depending on unit selection		
	<b>High Frequency (Optional)</b>	<b>1”</b>	<b>2”</b>	Pulse width 1.1 ms, min - max frequency, 3 - 150 hz
	<b>Unit/Pulse</b>	80	30	
<b>Empty Pipe Detection</b>		Hardware/software, conductivity-based		
<b>Conductivity</b>		>20 microSiemens		
<b>Environmental</b>		NEMA 4X standard		
<b>Electrical Connection (WMP101 Only)</b>		5 pin male circular connector, mates to industry standard cable <b>Note:</b> Cable and fitting kit must be ordered separately		

\*Specifications subject to change • Please consult our website for current data ([www.seametrics.com](http://www.seametrics.com))

### DIMENSIONS

#### 1 Inch

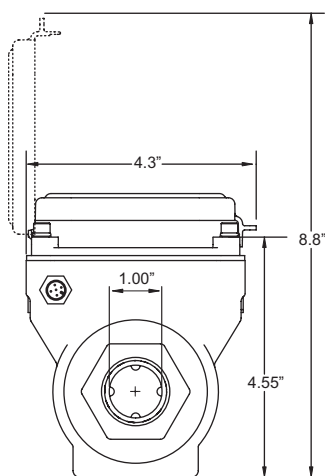

Power/Output Cable  
- WMP101 Only

#### 2 Inch

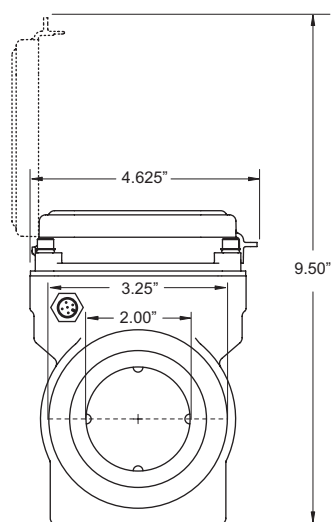

Use Banjo® fittings or  
Seametrics WMP Fitting Kit

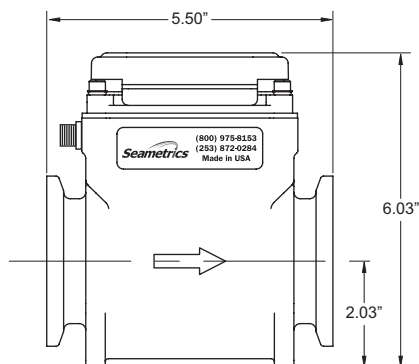
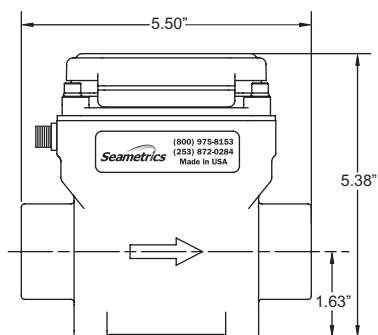

### STRAIGHT PIPE RECOMMENDATIONS

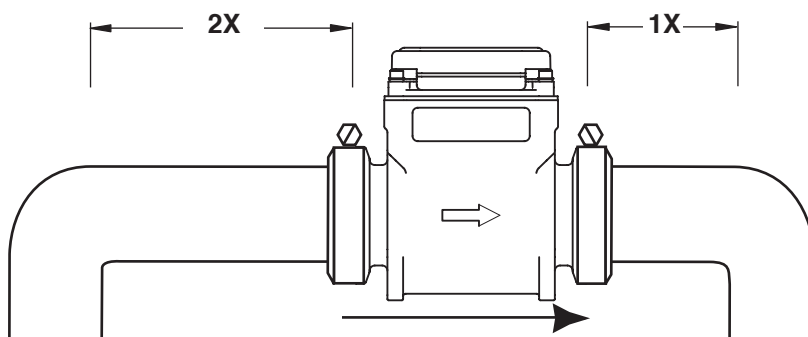

*Minimal straight pipe  
required between elbows.  
For other piping configurations,  
consult factory.*

### FLOW RANGE

	1"		2"	
	Gal/Min	Liter/Sec	Gal/Min	Liter/Sec
Minimum	2.3	.145	6	.38
Maximum	110	6.94	300	18.9



# WMP-Series Plastic-Bodied Magmeter

## HOW TO ORDER

MODEL	SIZE	OPTIONS	UNITS			
External Power = <b>WMP101</b>	1" = -100	Tamper-evident seal, screws, and wire = -32	<u>RATE</u>	<u>ORDER</u>	<u>TOTAL</u>	<u>ORDER</u>
			Gal/Min	= <b>GPM</b>	Gal	= <b>G</b>
			Liters/Sec	= <b>LPS</b>	Gal x 1000	= <b>GT</b>
			Liter/Min	= <b>LPM</b>	Cubic Feet	= <b>CF</b>
Battery Power = <b>WMP104</b>	2" = -200	Extended Battery Life = -133 (WMP104 Only)	Cu Ft/Sec	= <b>CFS</b>	Acre Inch	= <b>AI</b>
			Cu Ft/Min	= <b>CFM</b>	Acre Feet	= <b>AF</b>
		*High frequency output = -HF (WMP101 Only)	Cu Met/Min	= <b>CMM</b>	Liter	= <b>L</b>
					Mega Liters	= <b>ML</b>
					Cubic Meters	= <b>CM</b>
		*See specifications for default.	Consult factory for additional units.			

ACCESSORIES	
20 foot (6m) cable for WMP101 = <b>32482</b>	Remote 4-20 mA (analog) signal = <b>AO55W</b> (-HF Option Required, WMP101 Only)
Seametrics WMP Fitting Kit = <b>31980</b> (for 2 inch model)	Remote Rate and Total Indicator = <b>FT420W</b> (-HF Option Required, WMP101 Only)
2 FNPT threaded adapters	Remote Data Logger = <b>DL76W</b> (WMP101 Only)
2 Flange clamps	
2 EPDM gaskets	

## CONTACT YOUR SUPPLIER